

Compression Ring

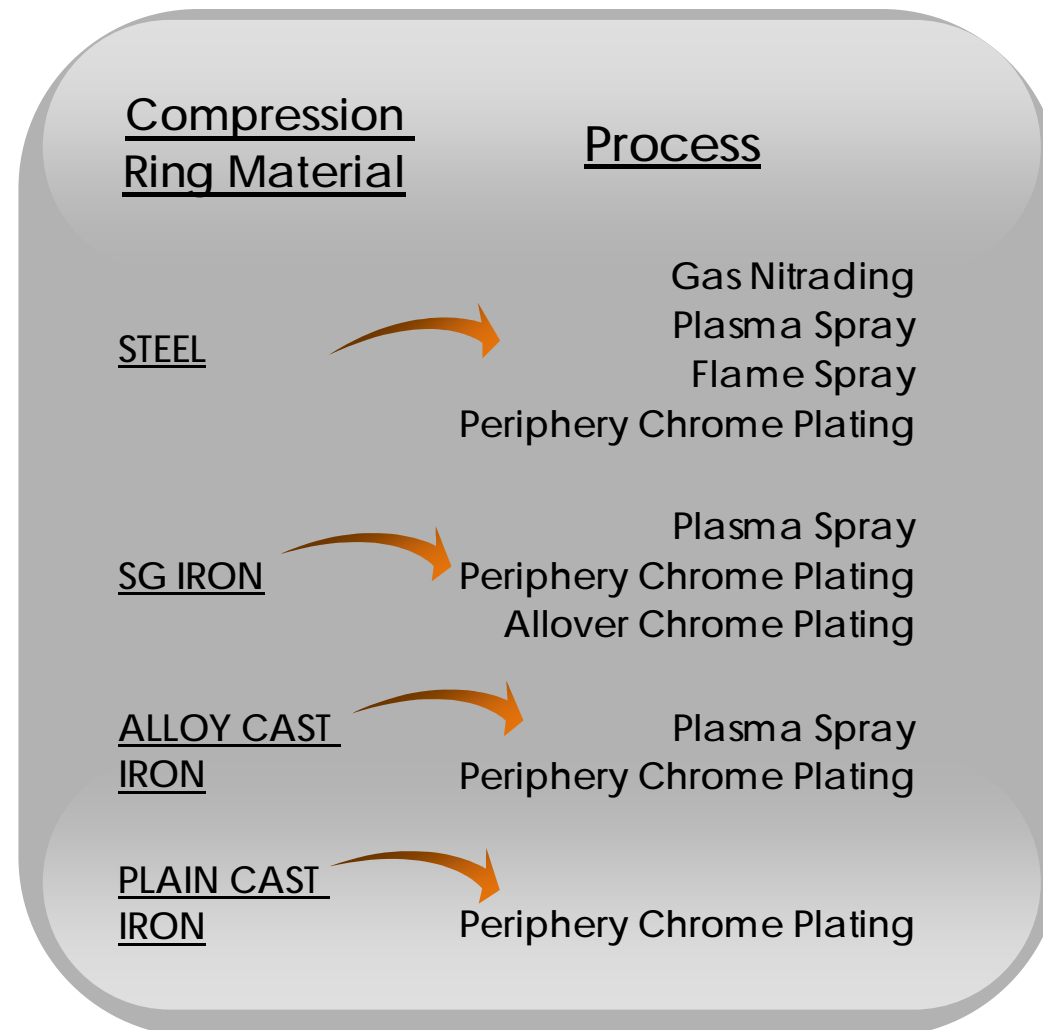

Top Compression Ring



**GNC - GAS NITRIDED
STEEL RECTANGULAR
CODE : 101**



**GNIBC - GAS NITRIDED
WITH INTERNAL BEVEL
CODE : 102**



**GNWC - GAS NITRIDED
WITH HALF KEYSTONE
CODE : 103**



**VC - OD CHROME
PLATED STEEL
CODE : 104**

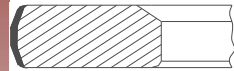

**VIBC - OD CHROME
WITH INTERNAL BEVEL
CODE : 105**

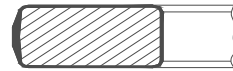

**VC - OD & SIDES
CHROME PLATED
CODE : 106**

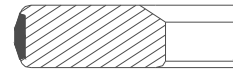

**ZVIBC - INLAY CHROME
WITH INTERNAL BEVEL
CODE : 107**

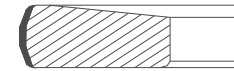

**WVC - OD CHROME
WITH HALF KEYSTONE
CODE : 108**

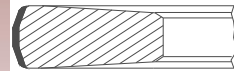

**KVC - OD CHROME
PLATED KEYSTONE
CODE : 109**

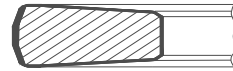

**KVC - OD & SIDES
CHROME KEYSTONE
CODE : 110**



**ZQC - INLAY MOLY
COATED
CODE : 111**

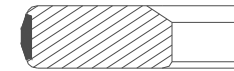

**ZQIBC - INLAY MOLY
WITH INTERNAL BEVEL
CODE : 112**

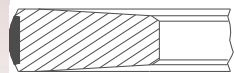

**ZQKC - INLAY MOLY
COATED KEYSTONE
CODE : 113**

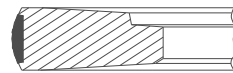

**ZQKISC - INLAY MOLY
KEYSTONE WITH ISC
CODE : 114**



**ZQC - FULL FACE
MOLY COATED
CODE : 115**

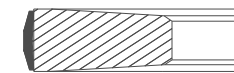

**ZQKC - FULL FACE
MOLY KEYSTONE
CODE : 116**

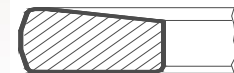

**GNWC - GAS NITRIDED
WITH HALF KEYSTONE
CODE : 117**

Second Compression Ring

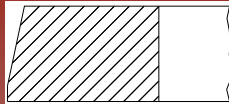

**TLC - OD TAPER
PERIPHERY PLAIN
CODE : 201**

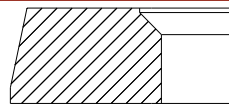

**TIBC - OD TAPER
WITH INTERNAL BEVEL
CODE : 202**



**TNS/MTNS - OD TAPER
WITH NAPIER STEP
CODE : 203**

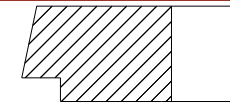

**TLSS - OD TAPER
WITH STEPPED SIDES
CODE : 204**

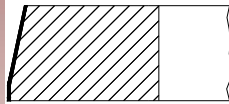

**VTLC - OD CHROME
WITH OD TAPER
CODE : 205**

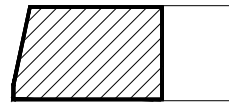

**VTLC - OD & SIDES
CHROME & OD TAPER
CODE : 206**

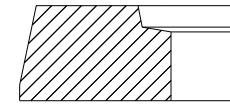

**TLISC - OD TAPER
WITH INTERNAL STEP
CODE : 207**

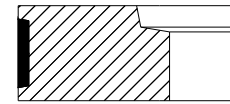

**ZQISC - INLAY MOLY
WITH INTERNAL STEP
CODE : 208**

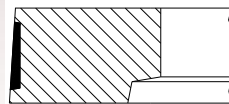

**MZVRTISC - INLAY CHROME
WITH REVERSE TWIST
CODE : 209**

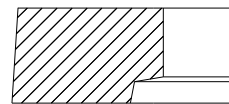

**MRTISC - OD TAPER
WITH REVERSE TWIST
CODE : 210**

Oil Ring

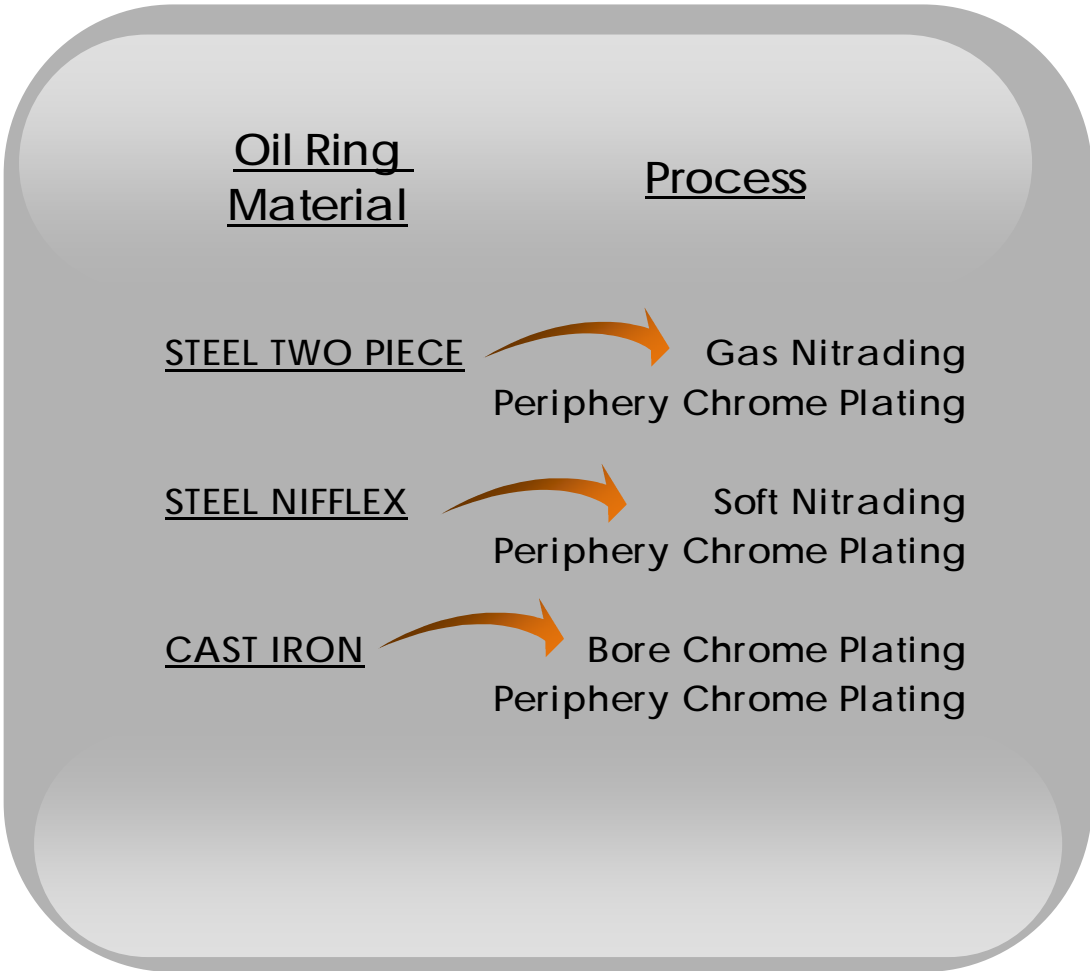

Oil Control Ring

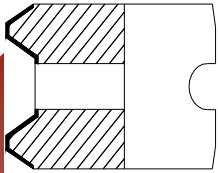

**VZSOC - OD CHROME
PLATED OIL RING
CODE : 301**

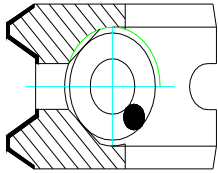

**VZSOCH - OD CHROME
CONFORMABLE OIL RING
CODE : 302**

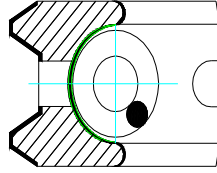

**VZSOCH - OD & ID CHROME
CONFORMABLE OIL RING
CODE : 303**

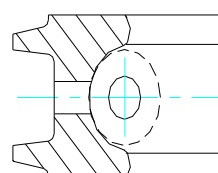

**GNSOCH - GAS NITRIDED
STEEL 2PIECE OIL RING
CODE : 304**

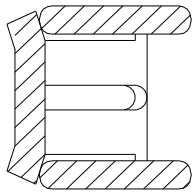

**TPR - SOFT NITRIDED
S' TYPE NIFFLEX
CODE : 305**

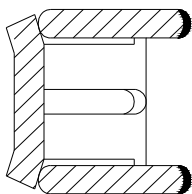

**TPR - OD CHROME
RAILS & 'S' TYPE NIFFLEX
CODE : 306**

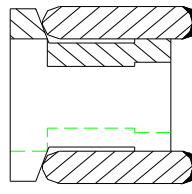

**TPR - OD CHROME RAILS
H' TYPE EXPANDER
CODE : 307**

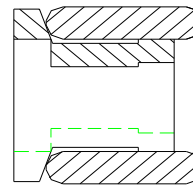

**TPR - SOFT NITRIDED
H' TYPE EXPANDER
CODE : 308**